

## Events and activities

Ranging from family activities and workshops for schools to expert talks, guided tours and craft fairs we have a busy programme of events. Check out the details on our website.

### Leonardo da Vinci: A Life in Drawing

01 Feb – 6 May 2019

'Leonardo da Vinci: A Life in Drawing' is a nationwide event which will give the widest-ever UK audience the opportunity to see the work of this extraordinary artist. To mark the 500th anniversary of the death of Leonardo da Vinci, the Royal Collection Trust has selected Sunderland Museum, Library & Winter Gardens to be one of 12 UK venues to host simultaneous exhibitions of 12 Leonardo da Vinci drawings.



Leonardo da Vinci, The drapery of a kneeling figure, c.1491-94  
Royal Collection Trust / © Her Majesty Queen Elizabeth II 2018



Sunderland Museum, Library & Winter Gardens  
Burdon Road, Sunderland SR1 1PP

Tel: 0191 561 2323

[www.seeitdoitsunderland.co.uk/](http://www.seeitdoitsunderland.co.uk/)  
[sunderland-museum-winter-gardens](http://sunderland-museum-winter-gardens)

#### Open

Monday to Saturday 10am-4pm, Sunday 12-4pm

Free entry

 @sunderlandmuseum

 @sundmuseum

**City Library is part of the  
Museum & Winter Gardens, opening times  
differ from the above. For details visit:**

[www.sunderland.gov.uk/libraries](http://www.sunderland.gov.uk/libraries)



oce21154



# Come on in and have some fun!



**SUNDERLAND**  
MUSEUM & WINTER GARDENS



# Venue plan

## Ground Floor

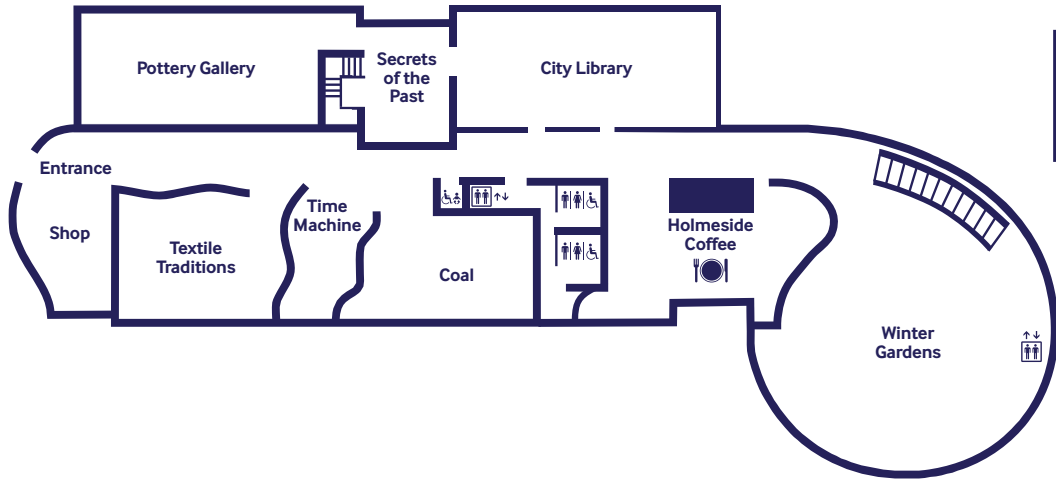

## Second Floor

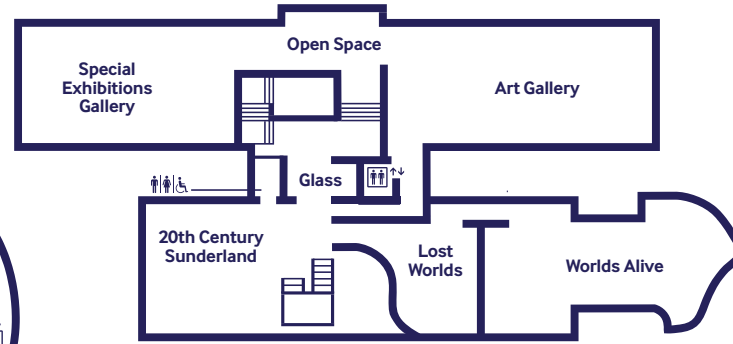

## First Floor

## Third Floor



- Lift
- Fully accessible toilets
- Disabled toilet and baby changing



Sunderland Museum, Library & Winter Gardens is a great place for groups and families to enjoy together. Learn all about the city, see wonderful exhibitions, stroll through our lush gardens or simply relax in our café.



Galleries devoted to the shipbuilding and coal mining industries tell of a remarkable heritage of which the city is rightly proud. Our unique collections of locally-made pottery and glass are among the best in the world.



Wallace, our famous lion, has his own membership club, Wallace's Warriors and is a favourite with both young and old. Wallace themed gifts and souvenirs can be purchased from our gift shop.



Come face to face with tigers, eagles and llamas and discover fossils and minerals in our natural history galleries. You might also find a dinosaur or two in our Winter Gardens and see plants from around the world.



If art is your thing then make your way to our beautiful art gallery, where you will see a selection of fine paintings as well as a large collection of work by artist LS Lowry.



With a lovely view over the Winter Gardens and park, our family friendly café Holmeside Coffee, serves a wide selection of snacks and drinks.